

FOR NOTES AND LEGENDS
REFER TO DRAWING No C700

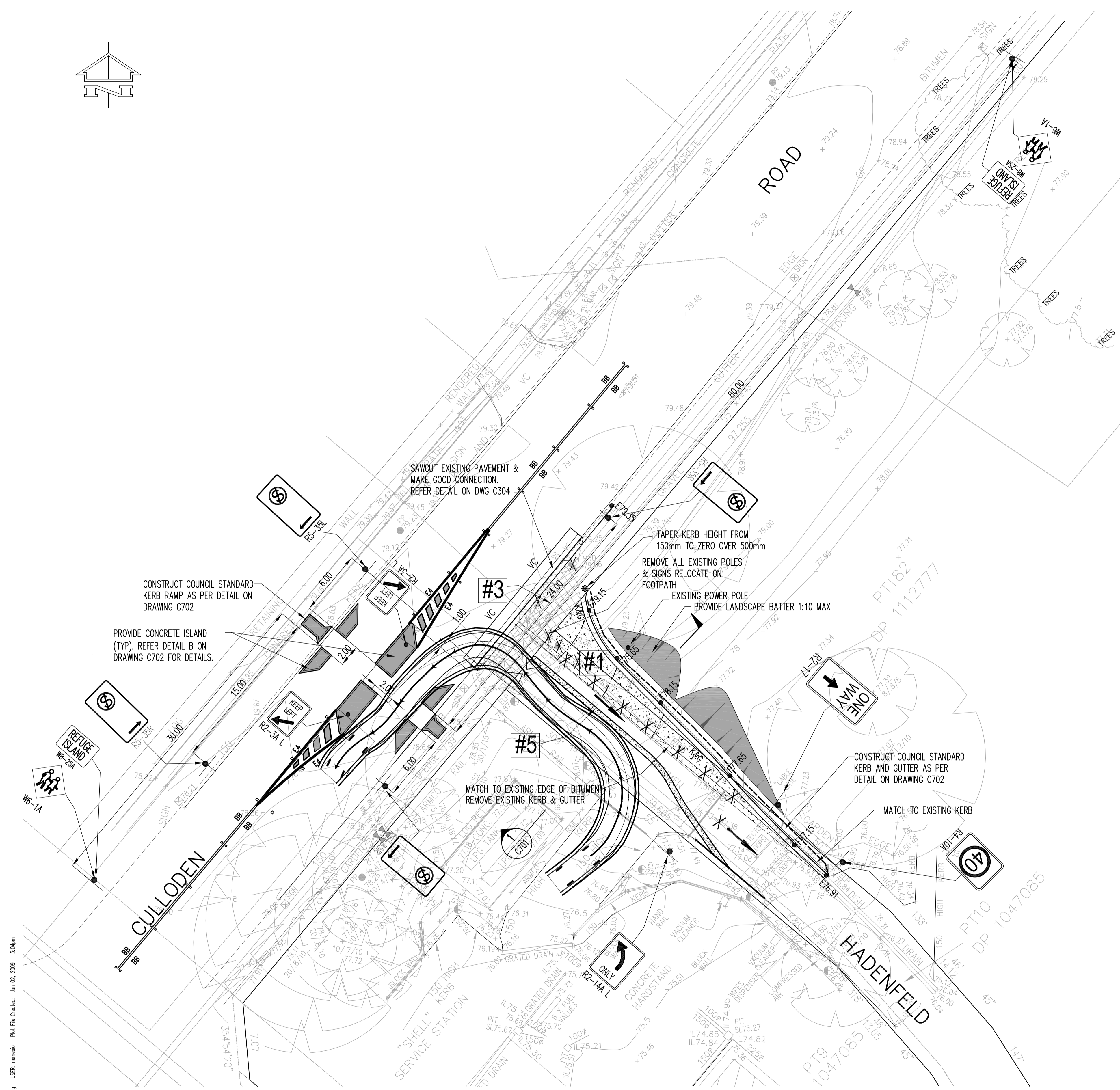
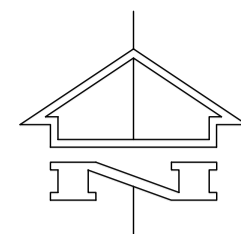

SERVICES NOTES:
 *Public Service Utility information shown on this plan has been compiled from information received from Dial Before You Dig inquiry, reference Number 3241575, which was obtained on 11/02/2009. Unless specifically shown otherwise, this location and depth of services shown on this plan have not been verified.
 The location of services shown on this drawing have been plotted as accurately as possible from diagrams provided by service authorities and should be confirmed by site inspection.*

NOTES:
 1. ALL SERVICES ARE APPROXIMATE ONLY AND ARE COMPILED FROM SERVICE UTILITY DRAWINGS. LOCATIONS ARE TO BE CONFIRMED IN FIELD PRIOR TO EXCAVATIONS
 2. CONSTRUCT PRAM RAMP IN ACCORDANCE WITH STANDARD PLAN A4 7284
 3. ALL EDGE LINES, GIVEWAY LINES TO BE PAINTED WHITE (THERMOPLASTIC). ALL OTHER LINES TO BE PAINTED WHITE (PAINT)
 4. RRP'S TO BE LOCATED ON THE ROAD CENTRELINE SIDE OF THE E4 LINE, I.E. INSIDE CENTRE TRAVEL LINES

ALL EXISTING SERVICES AFFECTED BY PROPOSED WORKS MUST BE REINSTATED TO THE RELEVANT AUTHORITIES REQUIREMENTS

CONTRACTOR IS TO LOCATE ALL EXISTING SERVICES PRIOR TO THE COMMENCEMENT OF WORK

File Name: C701.dwg - USER: nemesis - Plot File Created: Jan 02, 2009 - 3:04pm

Rev	Description	Eng	Draft	Date
P1	ISSUE FOR APPROVAL	NB	EN	02.06.09

Client
MACQUARIE UNIVERSITY
 OFFICE OF MAJOR PROJECTS
 SYDNEY NSW 2109
 PH: 9850 7111

Project Manager
DEFINITY GROUP
 PO BOX 3054
 BELLEVUE HILL NSW 2023
 PH: (02) 8354 1822

TaylorThomsonWhitting
 Consulting Engineers
 48 Chandos Street St Leonards NSW 2065
 T: +61 2 9439 7288 F: +61 2 9439 3146 ttw@ttw.com.au
 Taylor Thomson Whitting (NSW) Pty Ltd A.C.N. 113 578 377

Project
TRAFFIC MANAGEMENT WORKS
BALACLAVA RD

Sheet Subject
SITeworks PLAN



PRELIMINARY

Scale : A1	Drawn	Authorised
1:200	EN	
Job No	Drawing No	Revision
071628	C701	P1
Plot File Created: Jun 02, 2009 - 3:04pm		