

ISSUE	DATE	DESCRIPTION
A	19/11/2020	ISSUED TO CLIENT
B	30/11/2020	ISSUED TO CLIENT

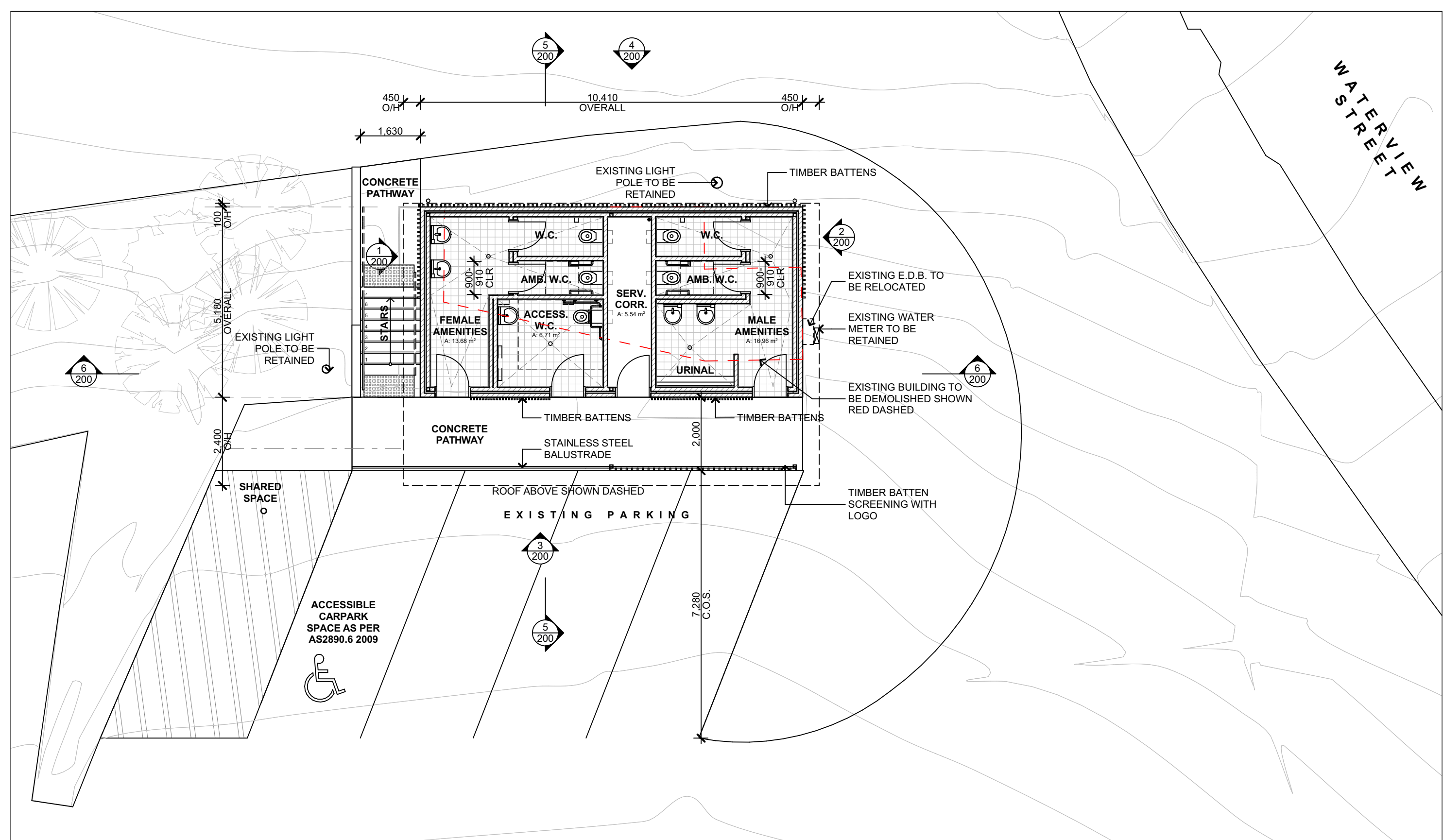

1 GROUND FLOOR PLAN
A1@1:100

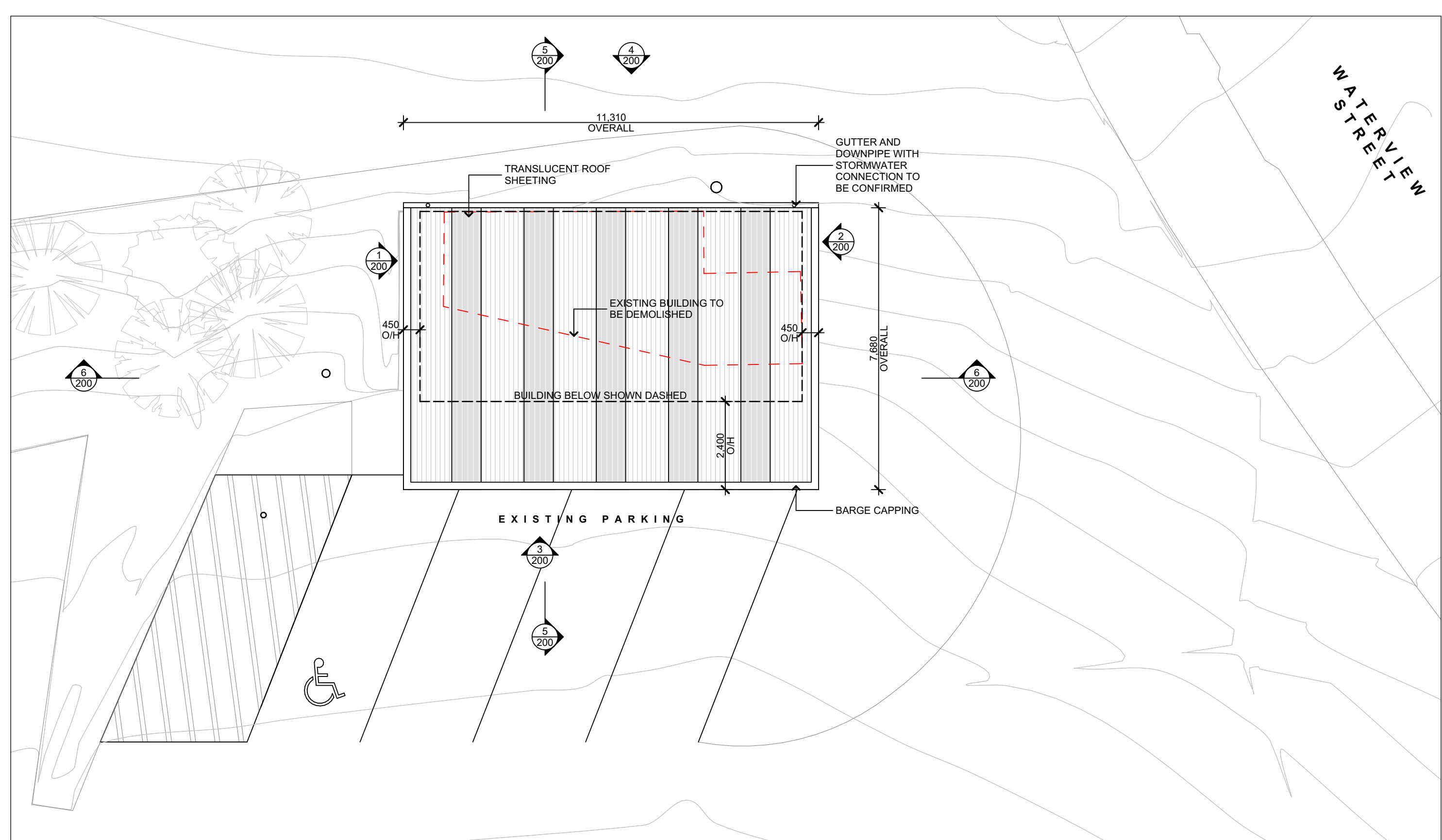

2 ROOF PLAN
A1@1:100



A PERSPECTIVE



B PERSPECTIVE



C PERSPECTIVE

FIGGIS + JEFFERSON TEPA

FIGGIS + JEFFERSON TEPA PTY LTD
220 Willoughby Road, Crows Nest, NSW 2065 Australia
E studio@fggis.com.au T 02 9438 5555
W www.fggis.com.au
ACN 002 875 505 + NSW Architects Registration
Board Nominated Architect Stephen Figgis 3565

This drawing is protected under the Copyright Act 1968 and is the copyright of Figgis and Jefferson TEPA. Do not reproduce, modify or transmit this drawing without the permission of Figgis and Jefferson TEPA. Do not scale this drawing. Use figured dimensions only. Confirm all dimensions and levels on site prior to commencement of any work, preparation of shop drawings or fabrication of components.

PROJECT
KISSING POINT PARK AMENITY BLOCK
FOR
CITY OF RYDE COUNCIL
AT
KISSING POINT PARK BOAT RAMP
WATERVIEW STREET, PUTNEY NSW 2112

DRAWING TITLE
FLOOR PLANS
ARCHITECT
JC

DRAWN
RC
TRUE NORTH

DRAWING NO.
3763 SK 110
ISSUE
B
SCALE