



City of Ryde  
Coxs Road Public Domain Upgrades  
Community Consultation 2 - Draft Concept Plan

S19-0079 R-201  
Issue C • 12/08/2020



# PROJECT OBJECTIVES

CLOUSTON associates



## Activate the street

- Improve outdoor seating and dining experiences



## Encourage social interaction

- Investigate opportunities for community plaza
- Provide shade areas for seating opportunities



## Improve access and circulation

- Create defined crossing points for pedestrians
- Improve uneven / unsafe footpaths



## Improve safety and amenity

- Replace uneven footpaths and create more consistency in materials and colours
- Improve visual amenity with planting
- Increase tree canopy coverage



## Reinforce the neighbourhood identity

- Create a sense of arrival into the neighbourhood centre
- Investigate opportunities for public art



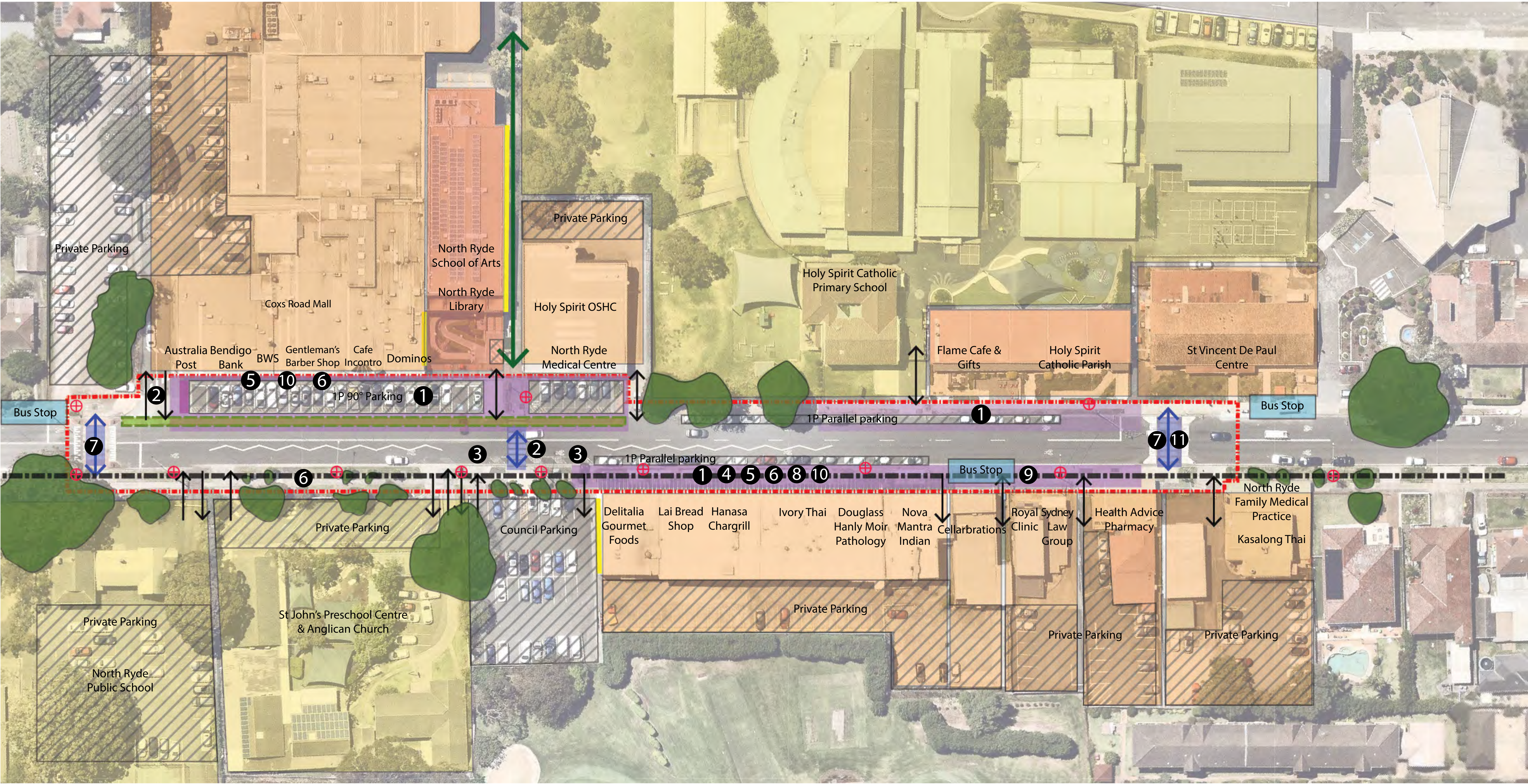

Legend

- Extent of works
- Driveway entry and exit
- Pedestrian crossings
- Areas of parking
- Overhead powerlines
- Bus stop
- Areas lacking tree shade
- Existing trees
- Cycle way
- Private Property
- School / Church
- Potential location for mural
- Pedestrian link
- Existing light poles

Key Findings

- 1 Lack of shade from trees
- 2 Unsafe road and pedestrian crossing
- 3 Potential to consolidate driveway entry and exits
- 4 Visually cluttered space (eg umbrellas under awning)
- 5 Raised planter beds prevent rainwater infiltration
- 6 Footpath is uneven or inconsistent material/colour
- 7 No sense of arrival to neighbourhood centre
- 8 Movable planters restrict the opening of car doors
- 9 Poor interface between shopfront and footpath
- 10 Outdoor dining underutilised and in variable conditions
- 11 Damaged raised pedestrian crossing



Client:  
City of Ryde

City of Ryde

Lifestyle and opportunity  
@ your doorstep



Coxs Road Public Domain Upgrades • NORTH RYDE

**SITE ANALYSIS**

S19-0079 R201 Sk 3

12/08/2020



ELEMENTS	ISSUE	OPPORTUNITIES	NOTE
Place identity	<ul style="list-style-type: none"> <li>Lack of sense of arrival and place identity</li> </ul>	<ul style="list-style-type: none"> <li>Introduce arrival feature tree at both end of the Coxs Road Small Centre precinct</li> </ul>	Structural soil system to be used to provide adequate soil volume Need to maintain clear sightlines
Public domain space Plaza in front of Community Hall / Library	<ul style="list-style-type: none"> <li>Lack of public space for socialising</li> <li>Lack of public amenity</li> <li>The two existing disabled parking spaces do not meet regulation</li> </ul>	<ul style="list-style-type: none"> <li>Increase plaza space for public domain</li> <li>Create a community plaza and social corner</li> <li>Standardise and provide two disabled parking spaces to meet regulation</li> </ul>	Considers a unified pavement treatment and extended seating Three 90 degree parking spaces to be converted to two disabled parking spaces to meet regulation
Seating opportunities*	<ul style="list-style-type: none"> <li>Lack of seating opportunities for socialising</li> <li>Lack of outdoor dining opportunities</li> </ul>	<ul style="list-style-type: none"> <li>Propose ample seating opportunities for public domain activation</li> <li>Structure of the seating bench on planter bed to be designed separately to provide flexible option where seat is not required</li> <li>Seating bench on planter bed forms part of outdoor dining experience</li> </ul>	Seats had been removed previously by Council due to loitering issue. Ample seating opportunities to be introduced for street activation to provide a safe environment and encourage people to sit and relax
Footpath	<ul style="list-style-type: none"> <li>Uneven surface with tripping hazard</li> <li>Inconsistent pavement materials throughout</li> </ul>	<ul style="list-style-type: none"> <li>Consistent and easily replaced pavement material throughout eg exposed aggregate concrete or the like</li> </ul>	Plaza could be highlighted by using feature unit paver
Road / pedestrian safety	<ul style="list-style-type: none"> <li>Unsafe pedestrian crossing in front of community hall / library due to adjacent driveways</li> </ul>	<ul style="list-style-type: none"> <li>Consolidate Council's carpark driveways to improve both road and pedestrian safety at this busy junction</li> </ul>	Three additional parking spaces could be achieved via driveway consolidation
On street parking - 90 degree parking	<ul style="list-style-type: none"> <li>Vehicles might accidentally drive across the footpath and into shop front causing injury and damage</li> </ul>	<ul style="list-style-type: none"> <li>Raised planter beds would act as a preventative measure for potential vehicle damage and injury to the public</li> <li>90 degree parking to be changed to "Rear to Kerb" only</li> </ul>	Rear to kerb will improve safety for the cyclist (dedicated cycle path) Wheel stops to be relocated where required to prevent vehicles reversing into raised planters
On street parking - Parallel parking	<ul style="list-style-type: none"> <li>Unmarked car parking means parking is not optimised</li> </ul>	<ul style="list-style-type: none"> <li>On street parallel parking to be linemarked to maximise the number of parking spaces</li> </ul>	-
Green canopy coverage	<ul style="list-style-type: none"> <li>Lack of street tree greenery and shade for pedestrians and vehicles.</li> </ul>	<ul style="list-style-type: none"> <li>Street tree planting in footpath and road to increase green canopy coverage to reduce urban heat island effect</li> <li>Street tree and understorey planting provide landscape amenity</li> </ul>	Structural soil system to be used for street tree planting where soil volume may be constrained by pavements
Shop front outdoor space	<ul style="list-style-type: none"> <li>Inefficient use of shop front space</li> </ul>	<ul style="list-style-type: none"> <li>Raised planter with seating opportunities form flexible shop front space</li> <li>Minimum 1.5m clearance for pedestrians required</li> <li>Proposed stand alone shade structure may assist with additional shade and shelter</li> </ul>	Need for clarity on ownership / management of street furniture

\*The centre is a daily destination for outpatients at the nearby Macquarie Hospital while shopkeepers and the community support the interaction of outpatients with the local community, concerns over public perceptions of their safety need to be addressed.



Client:  
City of Ryde



Coxs Road Public Domain Upgrades • NORTH RYDE

## ISSUE AND OPPORTUNITIES

S19-0079 R201 Sk 4

12/08/2020



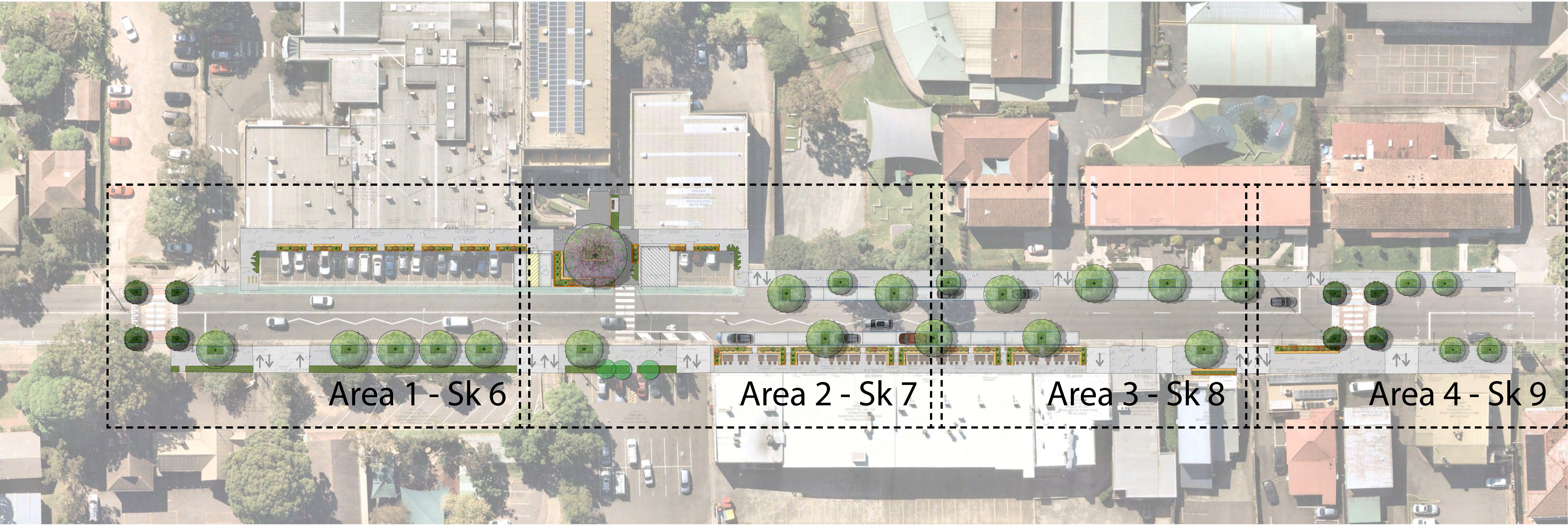

AREA 1 CONCEPT SUMMARY

- Feature Gateway Trees to create a sense of arrival
- Raised planters between 90 degree parking and shop front
- Street tree planting in footpath
- Consistent pavement materials throughout

AREA 2 CONCEPT SUMMARY

- Kerb realignment in front of library
- Enlarged plaza space with feature tree
- Disabled parking relocation and standardisation
- Council's carpark driveway consolidation
- Existing trees to be retained where possible
- Linemarked parallel parking
- Street tree planting in road between parkings
- Street tree planting in footpath
- Raised planters with stand alone shade structure
- Feature pavement in plaza
- Consistent pavement materials throughout

AREA 3 CONCEPT SUMMARY

- Linemarked parallel parking
- Street tree planting in road between parking
- Street tree planting in footpath
- Raised planters with independent shade structure
- Raised planter to mitigate footpath level changes
- Consistent pavement materials throughout

AREA 4 CONCEPT SUMMARY

- Feature Gateway Trees to create a sense of arrival
- Street tree planting in footpath
- Raised planter to mitigate footpath level changes
- Consistent pavement materials throughout

Legend

	Proposed Pavement		Proposed Bollards		Proposed Structural Soil System		Proposed Seats on Planter wall		Proposed Feature Plaza Tree		Bike Racks
	Mass Planting		Proposed MFP		Proposed Planter Wall		Proposed Gateway Tree		Proposed Street Tree		Existing Tree



Client:  
City of Ryde

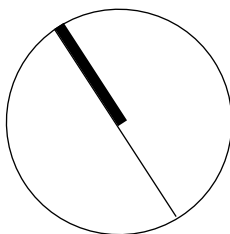
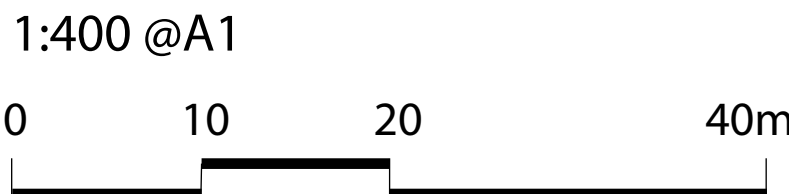

Coxs Road Public Domain Upgrades • NORTH RYDE

OVERALL DRAFT CONCEPT PLAN

S19-0079 R201 Sk 5

12/08/2020



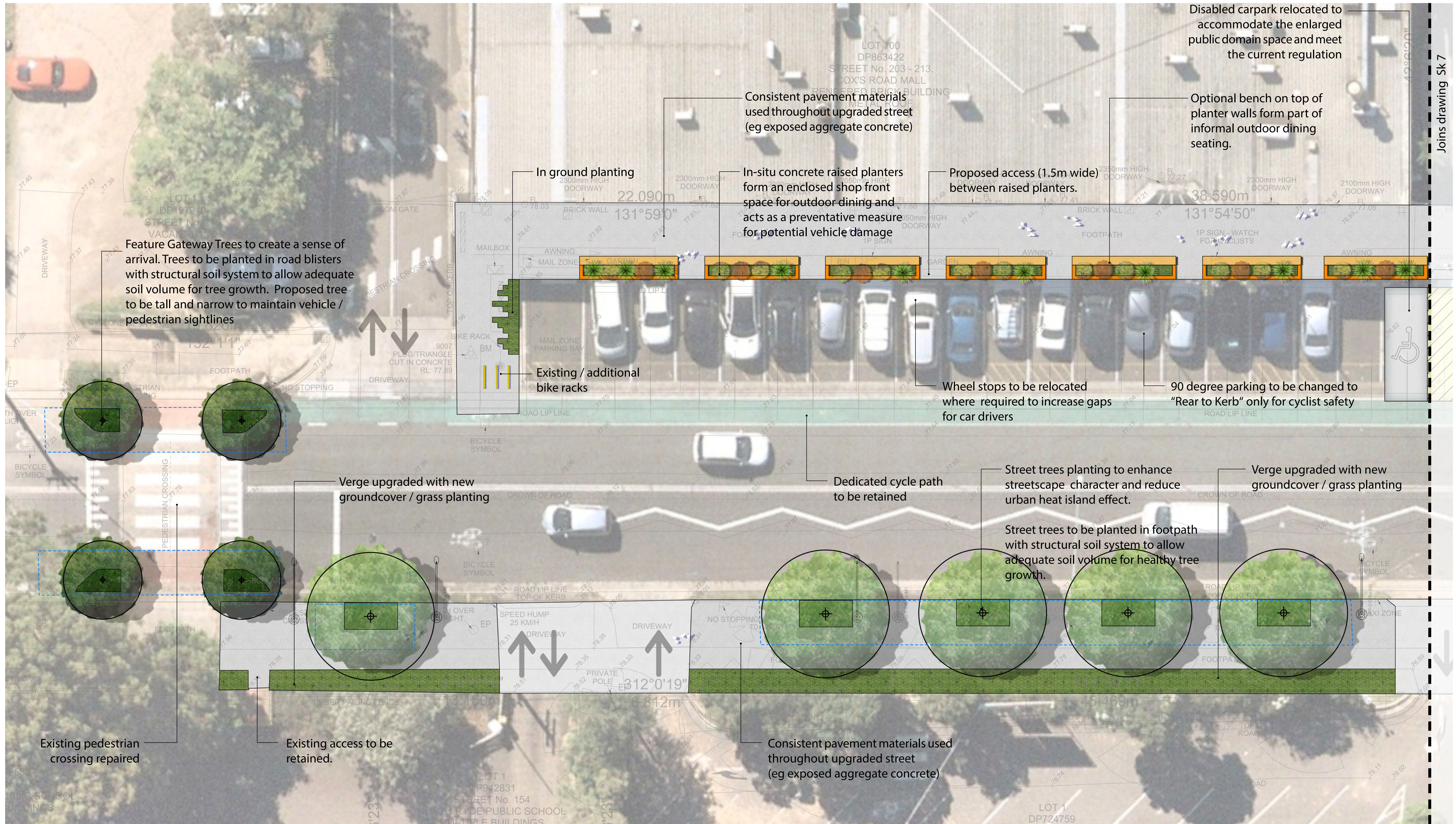

## Legend

	Proposed Pavement		Proposed Bollards		Proposed Structural Soil System		Proposed Seats on Planter wall		Proposed Feature Plaza Tree		Bike Racks
	Mass Planting		Proposed MFP		Proposed Planter Wall		Proposed Gateway Tree		Proposed Street Tree		Existing Tree



Client:  
City of Ryde



1:100 @A1

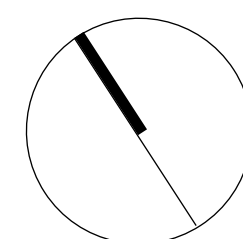
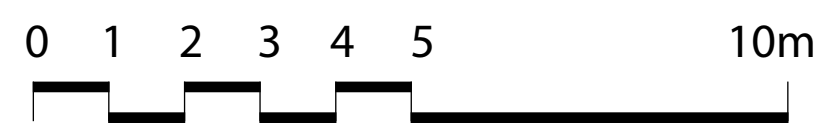

Coxs Road Public Domain Upgrades • NORTH RYDE

DRAFT CONCEPT DESIGN - PAGE 1 OF 4

S19-0079 R201 Sk 6

12/08/2020



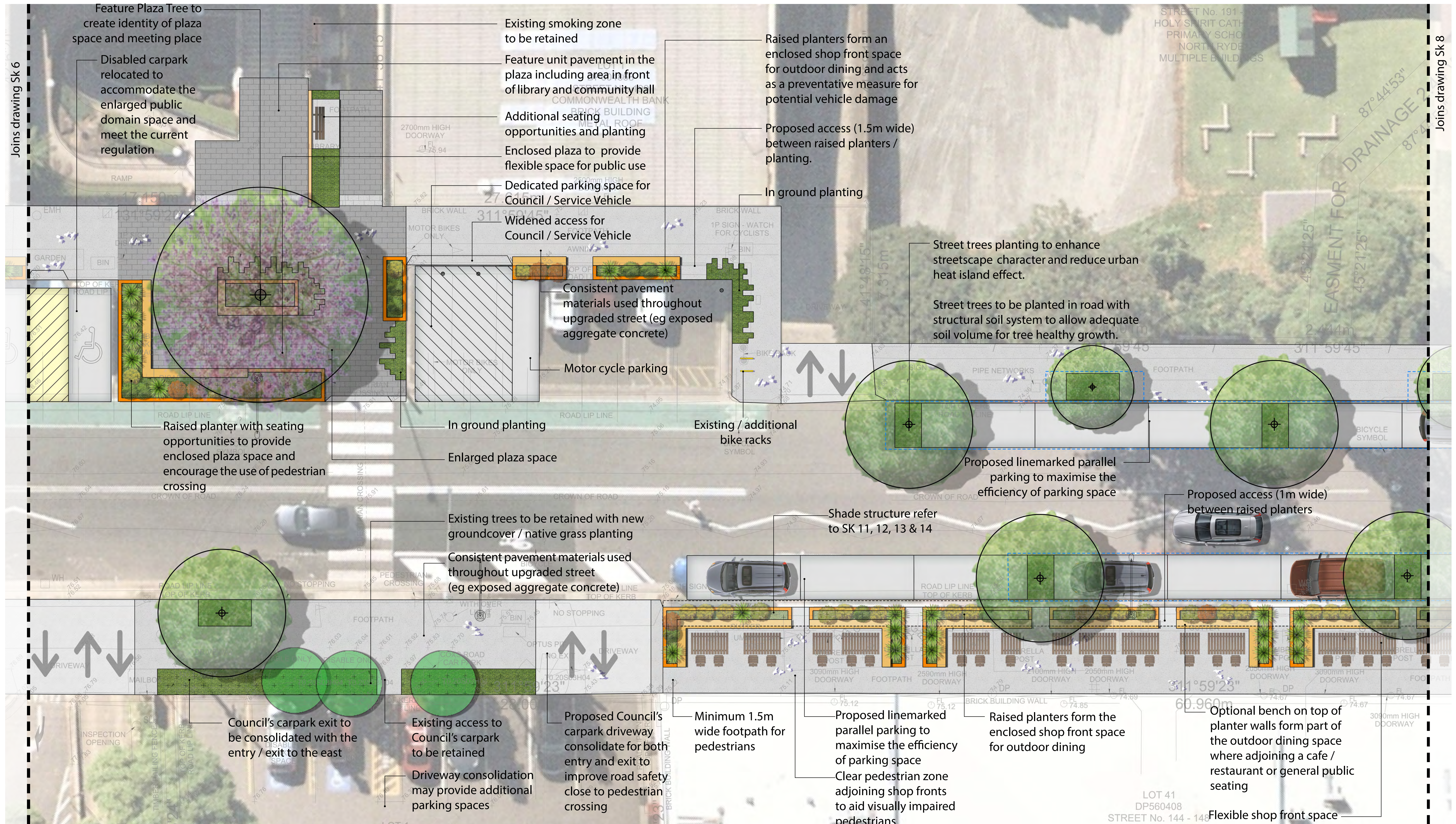

Legend

	Proposed Pavement		Proposed Bollards		Proposed Structural Soil System		Proposed Seats on Planter wall		Proposed Feature Plaza Tree		Bike Racks
	Mass Planting		Proposed MFP		Proposed Planter Wall		Proposed Gateway Tree		Proposed Street Tree		Existing Tree



Client:  
City of Ryde



1:100 @A1

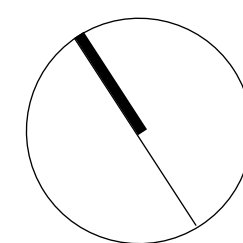
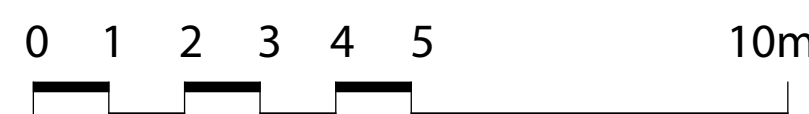

Coxs Road Public Domain Upgrades • NORTH RYDE

DRAFT CONCEPT DESIGN - PAGE 2 OF 4

S19-0079 R201 Sk 7

12/08/2020







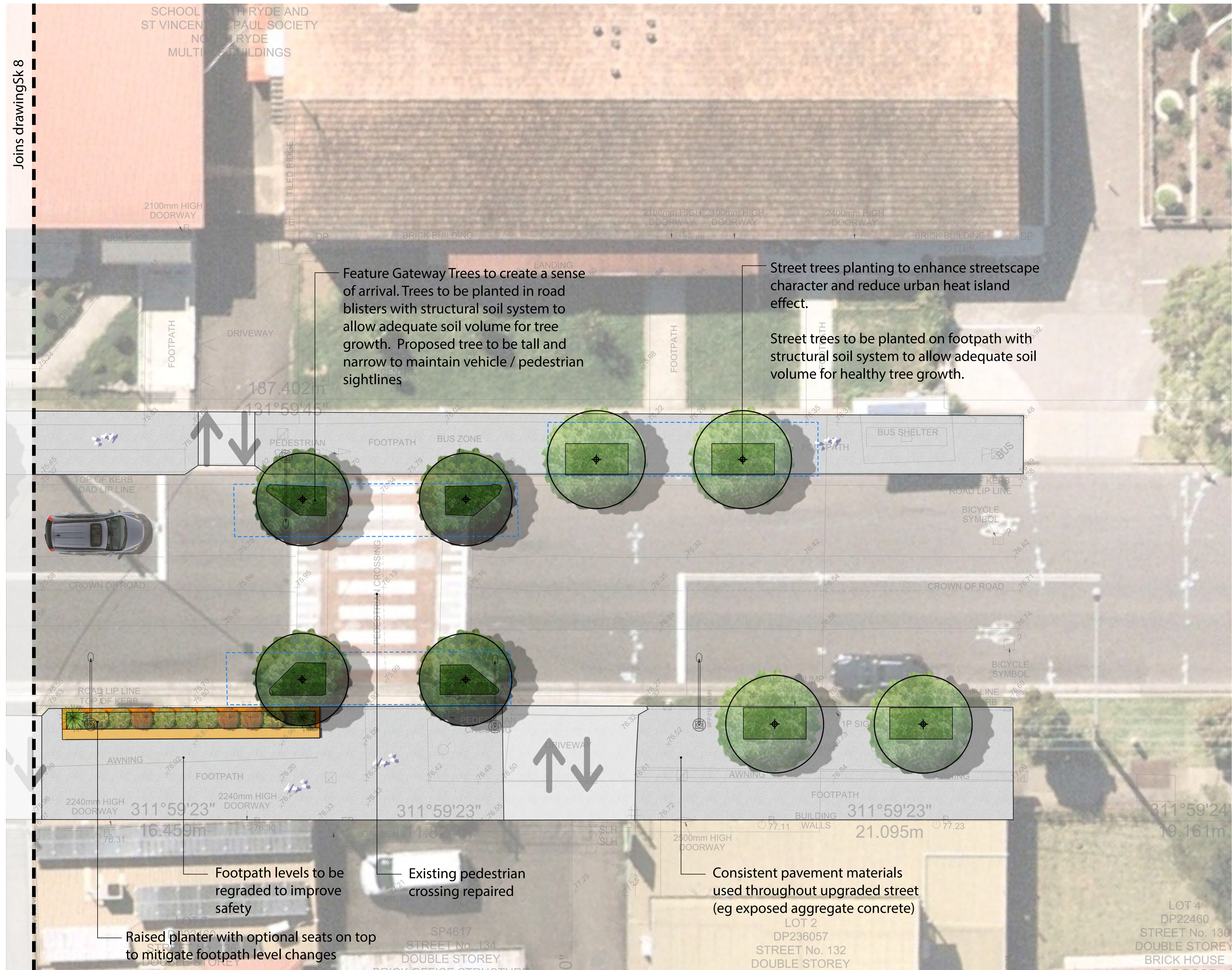

Legend

	Proposed Pavement		Proposed Bollards		Proposed Structural Soil System		Proposed Seats on Planter wall		Proposed Feature Plaza Tree		Bike Racks
	Mass Planting		Proposed MFP		Proposed Planter Wall		Proposed Gateway Tree		Proposed Street Tree		Existing Tree



Client:  
City of Ryde



1:100 @A1

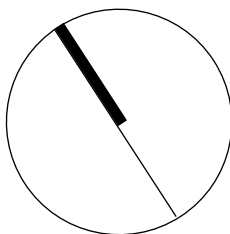
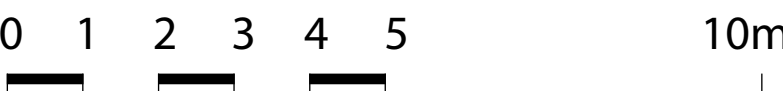

Coxs Road Public Domain Upgrades • NORTH RYDE

DRAFT CONCEPT DESIGN - PAGE 4 OF 4

S19-0079 R201 Sk 9

12/08/2020





Client:  
City of Ryde



LANDSCAPE ARCHITECTS • URBAN DESIGNERS • LANDSCAPE PLANNERS

• 65-69 KENT STREET • SYDNEY NSW 2000 • PO BOX R1388 • ROYAL EXCHANGE NSW 1225 • AUSTRALIA • SYDNEY@CLOUSTON.COM.AU • TELEPHONE +61 2 8272 4999 • FACSIMILE +61 2 8272 4998

Coxs Road Public Domain Upgrades • NORTH RYDE

SHADE STRUCTURE DRAFT CONCEPT - PAGE 1 OF 4

S19-0079 R201 Sk 10

12/08/2020

P:\S19\S19-0079 COXS ROAD SMALLS CENTRE UPGRADE\06 LAYOUT\A REPORTS\S19-0079 COXS ROAD PUBLIC DOMAIN UPGRADE\_CONSULTATION 2.INDD • LAST PRINTED ON 12/08/2020 05:09PM







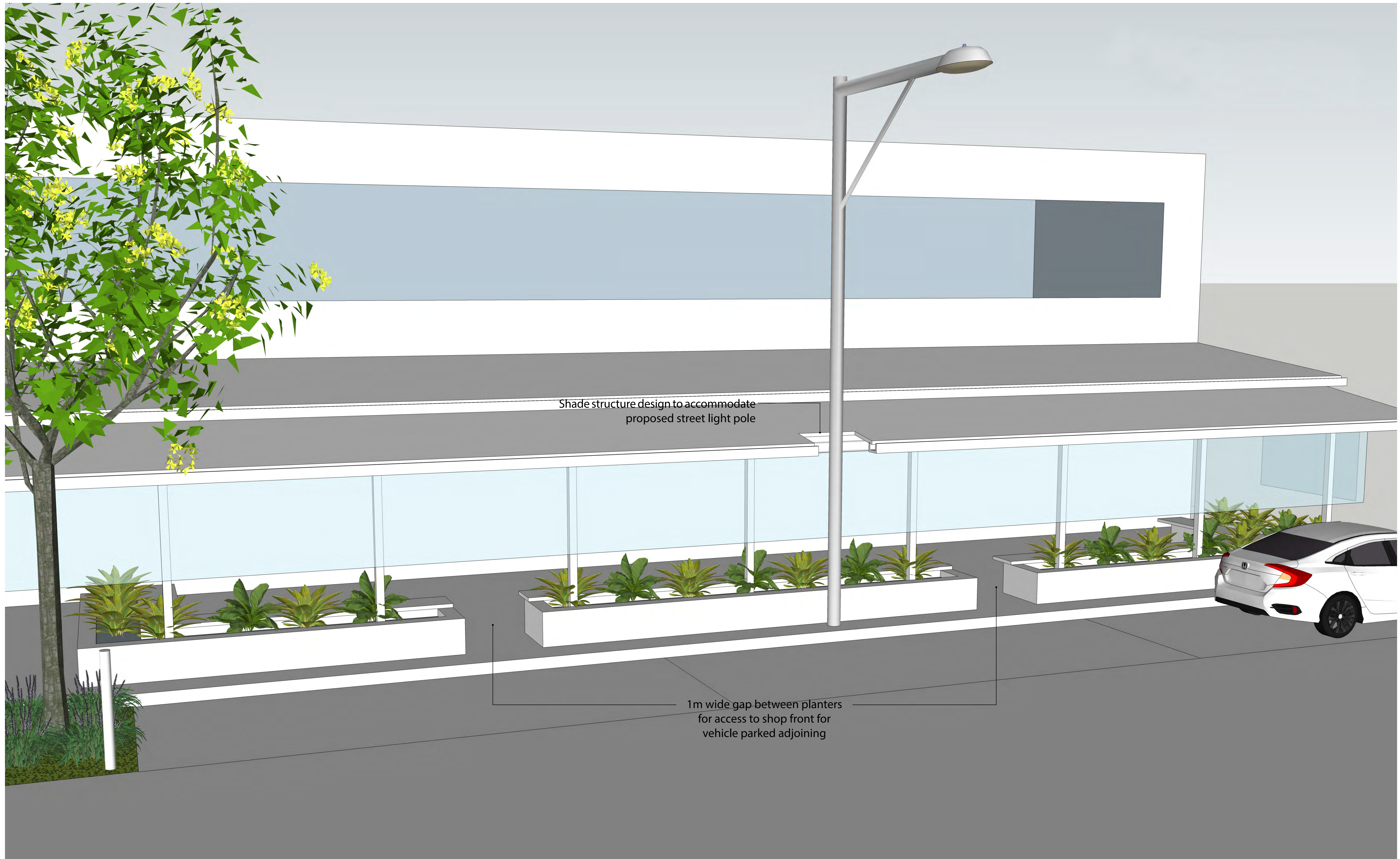



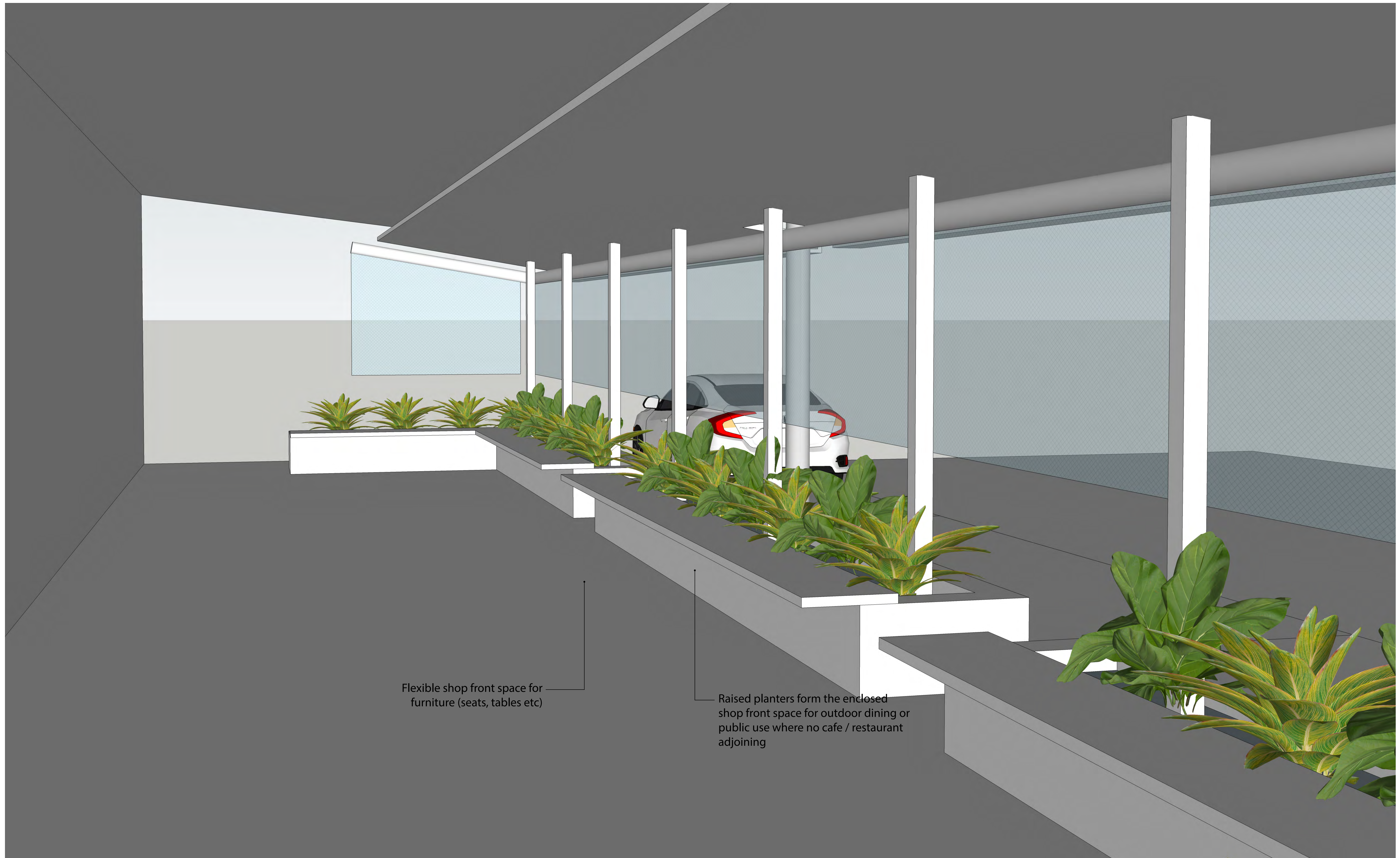

Flexible shop front space for  
furniture (seats, tables etc)

Raised planters form the enclosed  
shop front space for outdoor dining or  
public use where no cafe / restaurant  
adjoining



Client:  
City of Ryde



Lifestyle and opportunity  
@ your doorstep

Coxs Road Public Domain Upgrades • NORTH RYDE

SHADE STRUCTURE DRAFT CONCEPT- PAGE 4 OF 4

S19-0079 R201 Sk 13

12/08/2020





Planters, furniture and trees create pleasant outdoor dining.



Consistent paving material creates contemporary appearance.



Street trees between parking spots provide shade and collect rainwater.



Arrival into neighbourhood centre defined by large trees and planters.



Improved planting and trees with seating opportunities help to create an activated street.



Trees planted within the road provide shade and collect rainwater.



Shade from trees create pleasant areas to sit.



Client:  
City of Ryde



LANDSCAPE ARCHITECTS • URBAN DESIGNERS • LANDSCAPE PLANNERS

• 65-69 KENT STREET • SYDNEY NSW 2000 • PO BOX R1388 • ROYAL EXCHANGE NSW 1225 • AUSTRALIA • SYDNEY@CLOUSTON.COM.AU • TELEPHONE +61 2 8272 4999 • FACSIMILE +61 2 8272 4998

Coxs Road Public Domain Upgrades • NORTH RYDE

PRECEDENT IMAGERY

S19-0079 R201 Sk 14

12/08/2020

P:\S19\S19-0079 COXS ROAD SMALLS CENTRE UPGRADE\06 LAYOUT\TA REPORTS\S19-0079 COXS ROAD PUBLIC DOMAIN UPGRADE\_CONSULTATION 2.INDD • LAST PRINTED ON 12/08/2020 05:09PM