



OLYMPIC PARK, RYDE

WORK NOTIFICATION | PLAYGROUND UPGRADE

Dear Resident,

The City of Ryde is committed to ensuring that all families have access to safe, accessible and high-quality parks. As part of our Playground Renewal Program, we will be upgrading the playground in Olympic Park, Ryde.

What will the work include?

The playground upgrade will include the installation of new play equipment, access pavements and additional seating to the existing picnic area, landscaping, and tree planting work.

Please see the Olympic Park Playground upgrade plan on the back of this flyer.

When will the work take place?

Construction is expected to commence **Thursday 21 March 2024** and is expected to be completed in **Early June 2024**, weather permitting.

Work will primarily be undertaken from Monday to Friday between 7.00am – 4.00pm and occasionally on Saturdays between 8.00am – 3.00pm.

What are the changed conditions during the work?

There will be fencing to barricade the work area and some pedestrian access will be altered for the duration of the work. The current playground and picnic area will also be unavailable.

Some noise disturbance can be expected at times while the work is completed, however the work will be managed to minimise disturbance to nearby residents as much as practically possible.

We apologise for any inconvenience this work may cause and appreciate your cooperation.



Olympic Park Playground Upgrade Plan

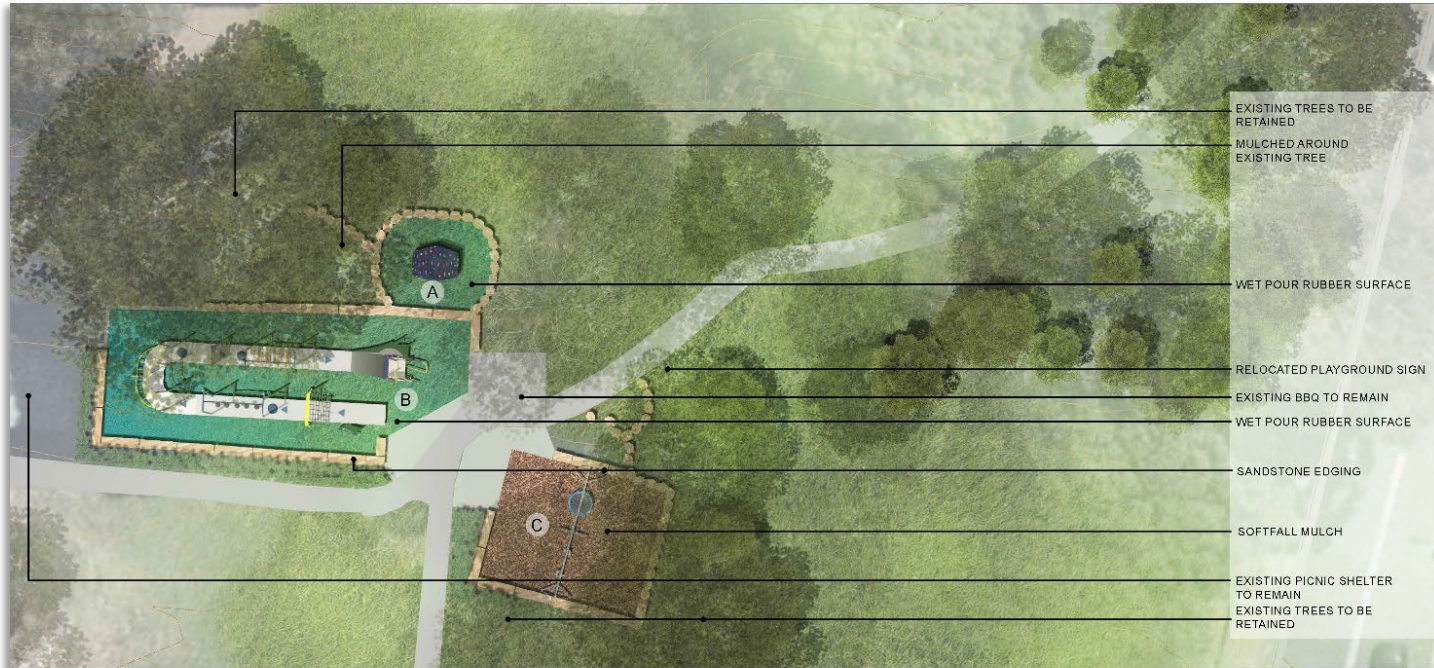

A CLIMBING CUBBY



B NINJA WARRIOR ACTIVE PLAY



C SWINGS



PLAYGROUND UPGRADE
OLYMPIC PARK, RYDE

CITY OF RYDE	DATE: 15 MAR 2024
ISSUE: NOTIFICATION	SCALE: NTS



For further information please contact:

Project Manager: Greg Norsa, City of Ryde

Phone: (02) 9952 8222

Email: GregN@ryde.nsw.gov.au

Visit: www.ryde.nsw.gov.au/projects
under Open Space, Sport and Recreation Program